

TOOL CHANGER SYSTEM

AGC-20

Download 2 & 3D CAD Drawings:
www.AGI-AUTOMATION.com

DIMENSIONAL DRAWING



SPECIFICATIONS

- Design** Fail-safe coupling
- Maximum Payload W.** 70 lbs
- Loading Capacity**
 - Max. Tension T 419 lbs @ 0 psi
 - Max. Compressive C 800 lbs
 - Max. Moment M_x 260 in-lb
 - Max. Moment M_y 260 in-lb
 - Max. Moment M_z 303 in-lb
- Accuracy**
 - Position Repeatability
 - X & Y ± 0.0001 in
 - Position Repeatability
 - Z ± 0.0001 in
- Pressure Range**
 - Low 30 psi
 - High 120 psi
- Temperature Range**
 - Low -20° F
 - High 180° F
- Material** High strength, hard coated aluminum alloys, steel
- Weight** 0.91 lb
- Ports (Standard)** (6) M5
- Electrical Contacts (Optional)** 18 @ 5 amps each

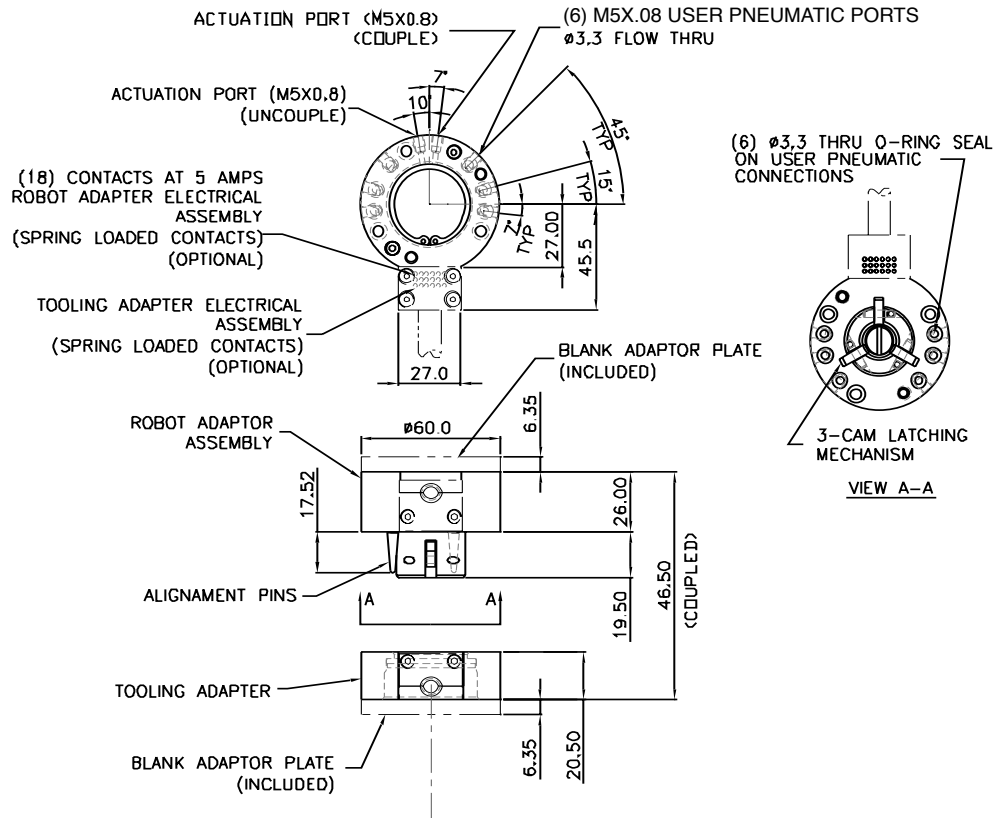

NOTE: Dimensions are metric.

LOADING INFORMATION

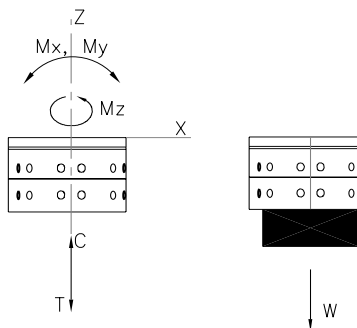

WARNING! Do not exceed maximum moment.

DEFLECTION DATA

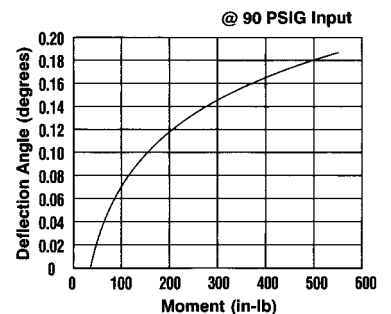

**TO ORDER OR FOR MORE INFORMATION, PLEASE CALL (203) 459-8345, FAX (203) 452-5943
VISIT OUR WEBSITE AT: WWW.AGI-AUTOMATION.COM**

AGC-20 TOOL CHANGER SYSTEM

LIFETIME WARRANTY ON LOCKING MECHANISM

FEATURES AND BENEFITS

- **Fail Safe** - The locking mechanism remains locked even with loss of pneumatic pressure.
- **Handles High Moments and Extremely High Repeatability** - The index pin gives Tool Change Adapters the ability to handle high radial moments, with high repeatability ± 0.001 in.
- **Fast Coupling** - The robot adapter can couple with the tool mounting adapter in less than 1/2 second.
- **Low Deflection** - The unique latching mechanism pulls the tool adapter into the robot adapter body - preloading the tool mounting adapter for excellent rigidity.
- **Coupling Window** - The robot adapter pulls up the tool adapter, allowing the user to couple while up to 0.04" off the face of the tool mounting plate.

THE TOOL CHANGER SYSTEM

We offer a full line of robotic tool changers designed to minimize assembly line downtime. We can increase your productivity:

- **When you're doing batchmode manufacturing.**
Reduce line changeovers from hours to seconds.
- **When you're maintaining or repairing tools.**
You can have a second identical tool available, that won't need recalibration.
- **When you need a more flexible robot.** Now your robot can perform multiple tasks with a simple tool change.

APPLICATIONS

- Pick and place
- Light to medium assembly
- Electronic assembly
- Material removal
- SMT work cells
- Clean room
- Material handling

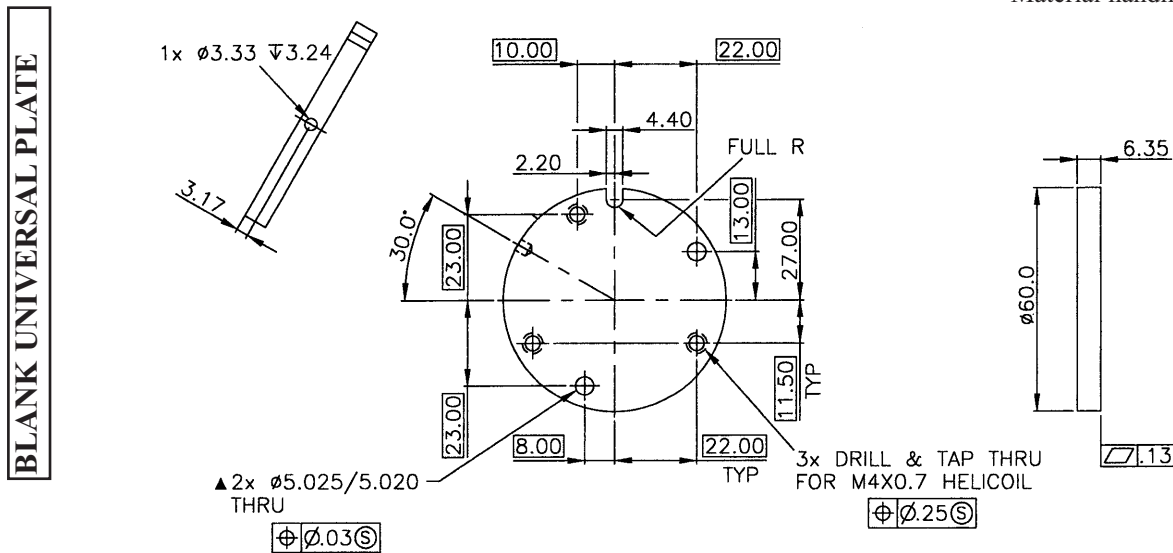

HOW TO ORDER

When ordering, please specify: Design/Model Number and Options.

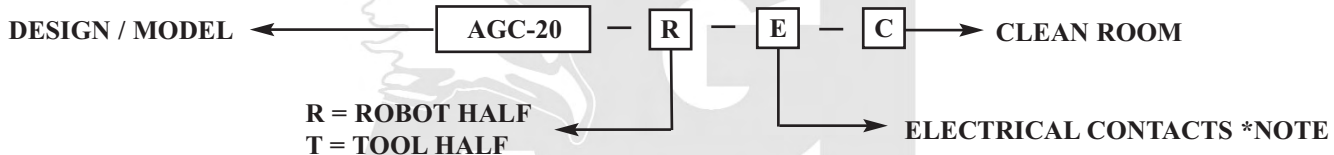

* NOTE 18 PIN CONTACTS COME WITH HIGH FLEX CABLE. ROBOT SIDE IS 3 METER AND TOOL SIDE IS 1/2 METER LONG

CONTACT INFORMATION

AGI AUTOMATION, INC.
 171 Spring Hill Road, Trumbull, CT 06611
 Tel: (203) 459-8345 • Fax: (203) 452-5943 • Email: amerigrip@aol.com
 www.agi-automation.com